

ROOM FINISH SCHEDULE

SPACE	TITLE	FLOOR FINISH	WALL FINISH	CEILING FINISH	CEILING MOULD	CEILING HEIGHT	DOOR TRIM	WAINSCOT	REMARKS	PAINTING WALL	PAINTING CEILING	PAINTING TRIM	REMARKS
201, 202	STAIR BALCONY	VARNISH	WOOD	PLASTER	PLASTER	12'-0"	WOOD	WOOD		PAINT	PAINT	PAINT	
203, 205	COAT ROOM	VARNISH	WOOD	PLASTER	PLASTER	12'-0"	WOOD	WOOD		PAINT	PAINT	PAINT	SEE DETAIL SHEET A-9
203	PROJECTION ROOM	VARNISH	WOOD	PLASTER	PLASTER	12'-0"	WOOD	WOOD		PAINT	PAINT	PAINT	SEE DETAIL SHEET A-9
204	REST ROOM	VARNISH	WOOD	PLASTER	PLASTER	12'-0"	WOOD	WOOD		PAINT	PAINT	PAINT	
207, 208, 209	REAR HALL	WOOD	WOOD	PLASTER	PLASTER	12'-0"	WOOD	WOOD		PAINT	PAINT	PAINT	
210, 211	CHANCELL STAIRS	WOOD	WOOD	PLASTER	PLASTER	12'-0"	WOOD	WOOD		PAINT	PAINT	PAINT	
212, 220	STAIR HALL	WOOD	WOOD	PLASTER	PLASTER	12'-0"	WOOD	WOOD		PAINT	PAINT	PAINT	
213, 219	CURTAIN ROOM	WOOD	WOOD	PLASTER	PLASTER	12'-0"	WOOD	WOOD		PAINT	PAINT	PAINT	
214	MENS LIVING ROOM	WOOD	WOOD	PLASTER	PLASTER	12'-0"	WOOD	WOOD		PAINT	PAINT	PAINT	
215	JAN TOILET	WOOD	WOOD	PLASTER	PLASTER	12'-0"	WOOD	WOOD		PAINT	PAINT	PAINT	
216	MENS TOILET	WOOD	WOOD	PLASTER	PLASTER	12'-0"	WOOD	WOOD		PAINT	PAINT	PAINT	
217	CLASSROOM	WOOD	WOOD	PLASTER	PLASTER	12'-0"	WOOD	WOOD		PAINT	PAINT	PAINT	
218	UPPER PART OF CHANCELL STAIRS	WOOD	WOOD	PLASTER	PLASTER	12'-0"	WOOD	WOOD		PAINT	PAINT	PAINT	
221	WORKING DRAWING ROOM	WOOD	WOOD	PLASTER	PLASTER	12'-0"	WOOD	WOOD		PAINT	PAINT	PAINT	
222	STORAGE	WOOD	WOOD	PLASTER	PLASTER	12'-0"	WOOD	WOOD		PAINT	PAINT	PAINT	
223	WORKING DRAWING ROOM	WOOD	WOOD	PLASTER	PLASTER	12'-0"	WOOD	WOOD		PAINT	PAINT	PAINT	
224	CLASSROOM	WOOD	WOOD	PLASTER	PLASTER	12'-0"	WOOD	WOOD		PAINT	PAINT	PAINT	
225	ORGAN CHAMBER	WOOD	WOOD	PLASTER	PLASTER	12'-0"	WOOD	WOOD		PAINT	PAINT	PAINT	
226	WRESTLING ROOM	WOOD	WOOD	PLASTER	PLASTER	12'-0"	WOOD	WOOD		PAINT	PAINT	PAINT	
227	CORRIDOR	WOOD	WOOD	PLASTER	PLASTER	12'-0"	WOOD	WOOD		PAINT	PAINT	PAINT	

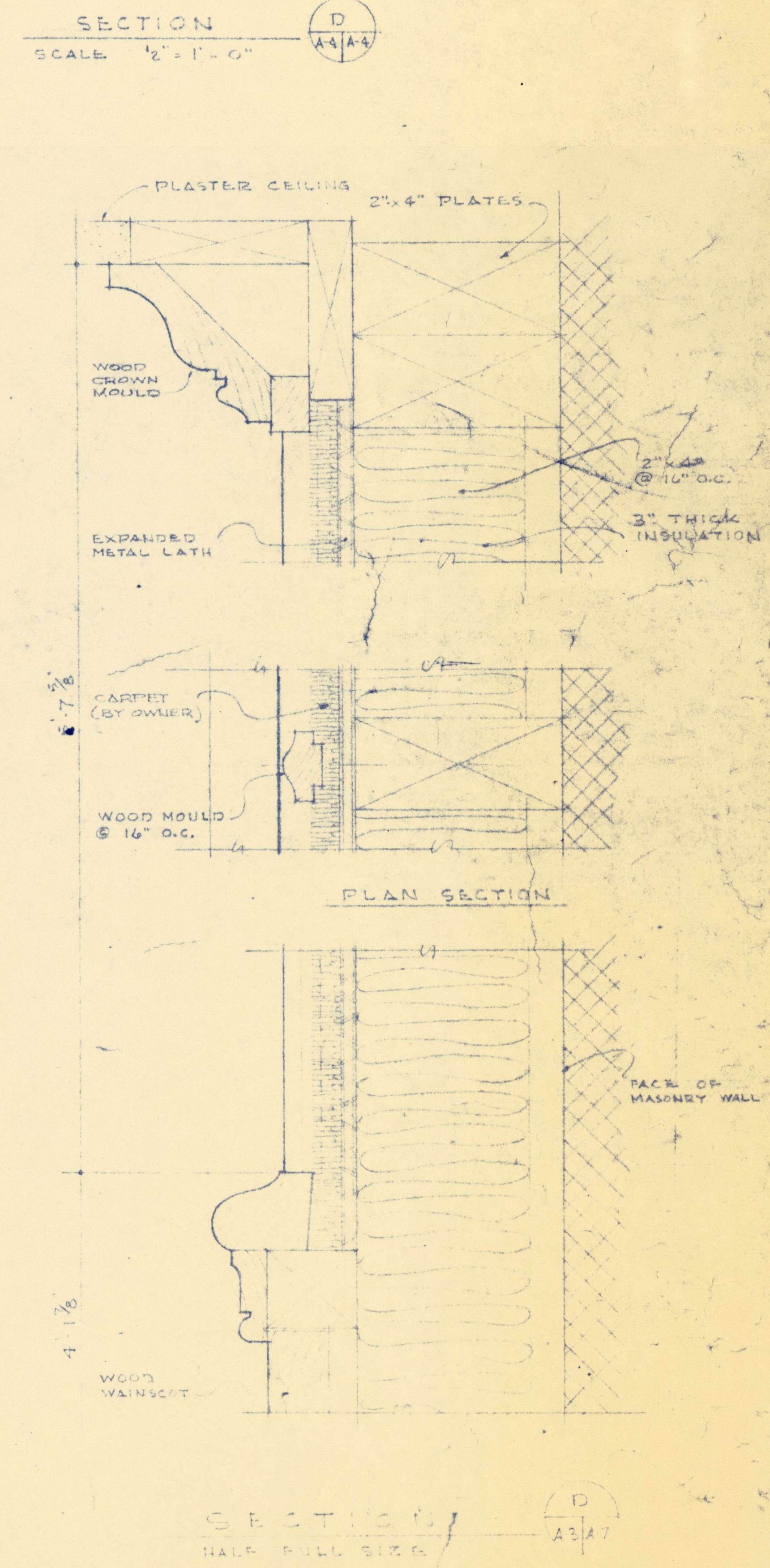
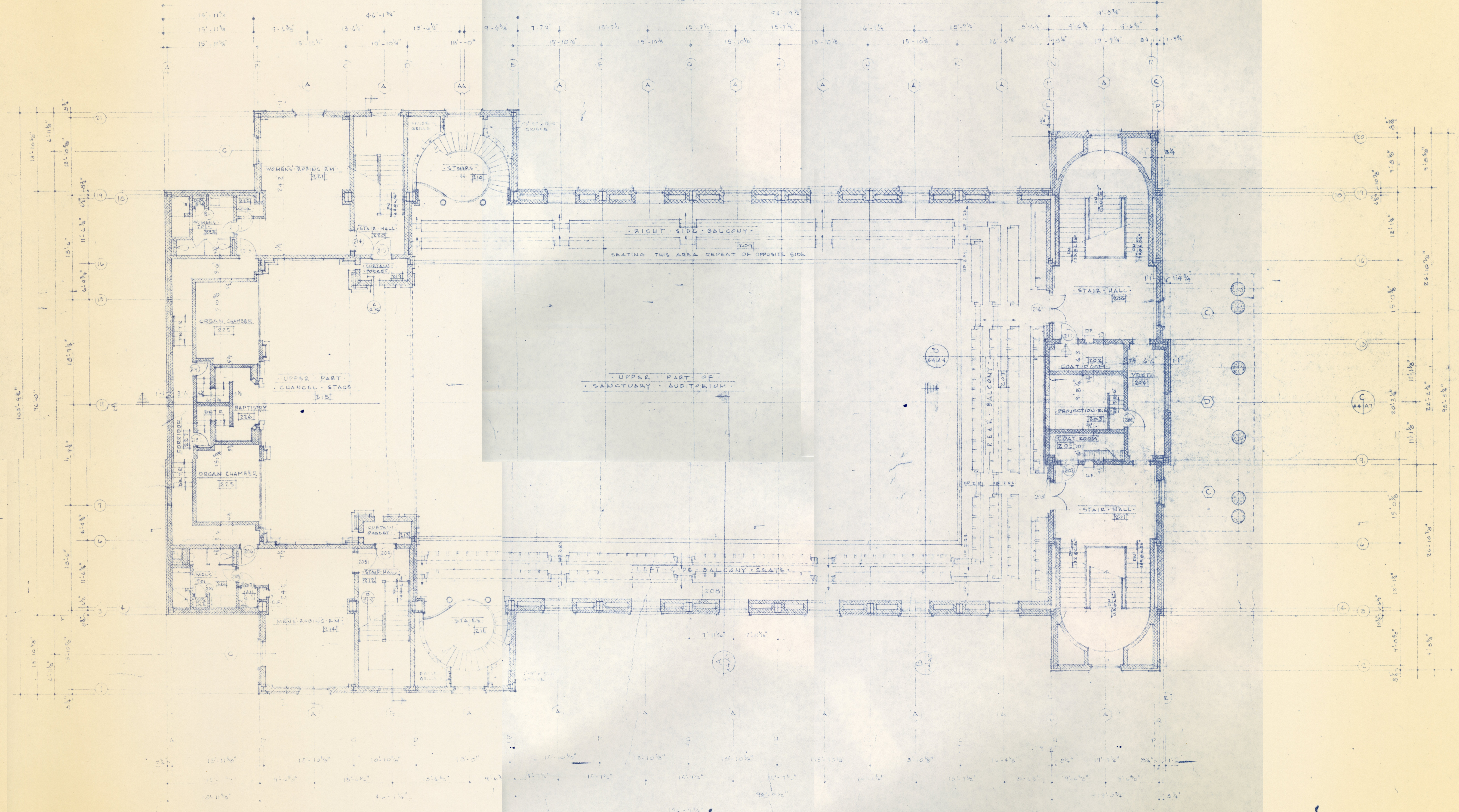
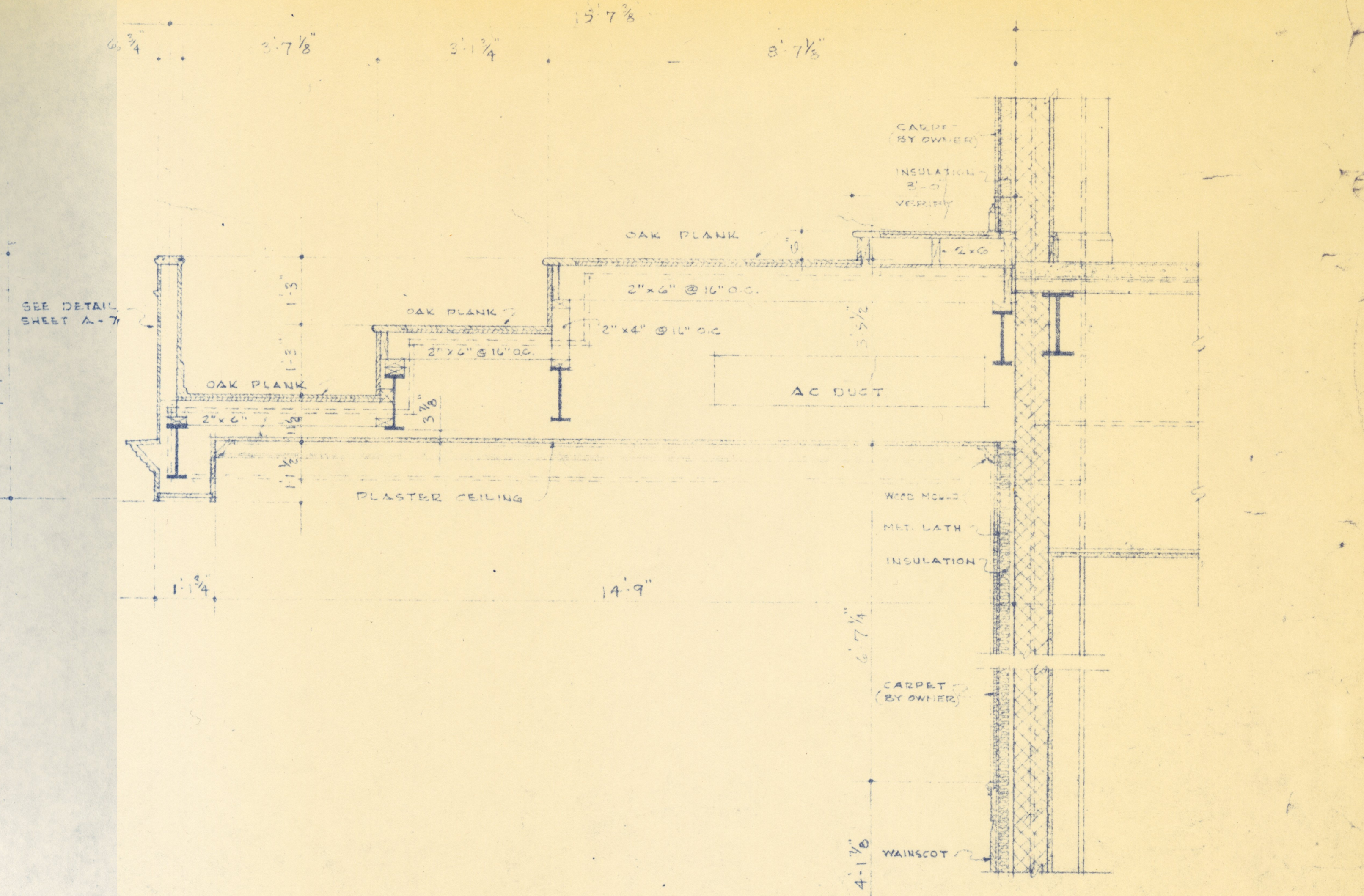

NOTE 1  
THIS SHEET CONTAINS THE REVISED FINISH SCHEDULE AS PROVIDED UNDER ALTERNATIVE OF AGREEMENT BETWEEN CONTRACTOR & OWNER AND LISTED UNDER PROPOSED CHANGES IN PLANS & SPECIFICATIONS, DATED FEB. 12, 1925.

CHAPLIER MILLIGAN & CO. ENGINEERS  
MILLIGAN COLLEGE TENNESSEE  
GODWIN & RAWLS ARCHITECTS  
MEMPHIS TENNESSEE